

Teleflex Marine Connection Kits

Control Connection Kits

DESCRIPTION OF KIT	MORSE	TELEFLEX
OEM Control-Specific Connection Kits for 3300/33C cables:		
Merc/Mariner Control Adapter - 3300/33C cable	301074	N/A
OMC/J/E Control Adapter - 3300/33C cable	304939	N/A



301074



304939

Engine Connection Kits

DESCRIPTION OF KIT	MORSE	TELEFLEX
Engine-Specific Connection Kits for O.E.M. cables:		
For 1973-1978 OMC O.E.M. ("400" type) cables with bare wire ends:		
Evinrude/Johnson O/B Kit (35HP & less)	035640	CA27208P
Evinrude/Johnson O/B Kit (over 35HP)	N/A	CA27247P
OMC Stern Drive Kit (all)	N/A	CA27247P
<i>(NOTE: included clip is not used on stern drives.)</i>		

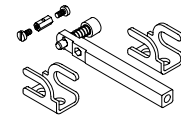

CA27208P

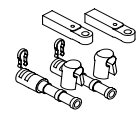

CA27247P

Engine-Specific Connection Kits for 3300/33C cables:		
Evinrude/Johnson O/B Kit (1979-date)	300557	CA27320P
Evinrude/Johnson O/B Kit (pre-1979)		CA27321P
Evinrude/Johnson O/B Kit	301729	
<i>(301729 adapts 2 3300/33C cables for use with Evinrude/Johnson 1978-date 55-235 HP, 1986 20 HP and up. 20, 25 and 30 HP motors may need OMC kit 397488 if motor does not already have it installed.)</i>		
Mercury Outboard Kit (1965-date)	301901	CA27319P
Mercury Stern Drive Kit (all)		CA27319P
Mercury Inboard Kit (all)	302123	CA27373P
OMC Stern Drive Kit (all)	300557	CA27320P

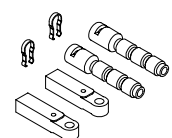

CA27320P

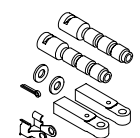

CA27321P

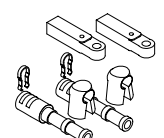

CA27319P

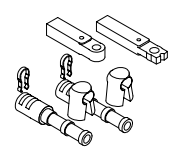

CA27373P



300557



301729



302123



301901

Universal Ball Joint Kits:		
Univ. 3300/33C Ball Joint (1/4-28) (1)	N/A	CA37701P
Univ. 3300/33C Ball Joint (10-32) QR (1)	031799-001	N/A
Univ. 3300/33C Ball Joint (1/4-28) QR (1)	031126	N/A
Univ. 3300/33C Ball Joint (5/16-24) QR (1)	035242	N/A
Univ. 4300/43 Ball Joint (1/4-28) (1)	N/A	CA28014P
Univ. 4300/43 Ball Joint (1/4-28) QR (1)	029104	N/A
Univ. 4300/43 Ball Joint (5/16-24) QR (1)	032267	N/A
Univ. 6400/64 Ball Joint (5/16-24) (1)	N/A	CA28021P
Univ. 6400/64 Ball Joint (5/16-24) QR (1)	029108	N/A
Univ. 6400/64 Ball Joint (5/16-24) ST (1)	038491	N/A
<i>(NOTE: QR type has external spring over ball receptor; ST does not.)</i>		

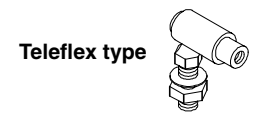

Teleflex type

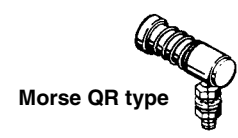

Morse QR type

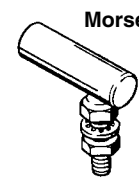

Morse ST type

CONTROL CABLES connection kits

control cable connection & accessory hardware

For two cables, except where otherwise noted.
(1) = for use with one cable.

DESCRIPTION OF KIT	MORSE	TELEFLEX
--------------------	-------	----------

Universal Clevis Kits:

Univ. 3300/33C Clevis (10-32, 1/4" pin) (1)	N/A	CA37700P
Univ. 3300/33C Clevis (10-32, 3/16" pin) (1)	031800	N/A
Univ. 3300/33C Clevis (10-32, 1/4" pin) (1)	031125	N/A
Univ. 3300/33C Clevis (10-32, 5/16" pin) (1)	033395	N/A
Univ. 4300/43 Clevis (1/4-28, 1/4" pin) (1)	029025	N/A
Univ. 4300/43 Clevis (1/4-28, 5/16" pin) (1)	042212	N/A
Univ. 4300/43 Clevis (1/4-28, 5/8" pin) (1)	045985	N/A
Univ. 6400/64 Clevis (5/16-24, 5/16" pin) (1)	029132-001	N/A
Univ. 6400/64 Clevis (5/16-24, 3/8" pin) (1)	042034	N/A

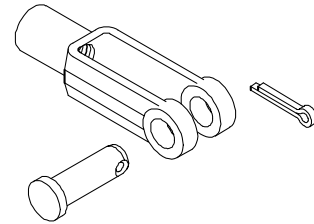

Other Universal Cable Connection Kits:

Pivots - 3300/33C Series:

	A	B	C	D	E		
in	3/16	7/16	3/8	9/64	11/16	045583	N/A
mm	4.8	11.1	9.5	3.6	17.5		
in	1/4	7/16	21/64	9/64	5/8	031029	N/A
mm	6.4	11.1	8.3	3.6	15.9		
in	1/4	7/16	3/8	.191	23.32	031539	N/A
mm	6.4	11.1	9.5	4.9	18.3		
in	1/4	7/16	21/64	.295	25/32	032392	N/A
mm	6.4	11.1	8.3	7.5	19.8		
in	1/4	7/16	3/8	.316	15/16	039890	N/A
mm	6.4	11.1	9.5	8.0	23.8		
in	1/4	1/2	3/8	.376	15/16	043939	N/A
mm	6.4	12.7	9.5	9.6	23.8		
in	5/16	7/16	3/8	13/32	1-1/16	037691	N/A
mm	7.9	11.1	9.5	10.3	27.0		
in	5/16	7/16	3/8	7/16	1	039471	N/A

Pivots - 4300/43 Series:

in	1/4	1/2	7/16	9/64	3/4	039110	N/A
mm	6.4	12.7	11.1	3.6	19.1		
in	1/4	1/2	1/2	13/64	7/8	031537	N/A
mm	6.4	12.7	12.7	5.2	22.2		
in	1/4	1/2	1/2	17/64	15/16	036361	N/A
mm	6.4	12.7	12.7	6.7	23.8		
in	5/16	1/2	9/16	9/64	29/32	045199	N/A
mm	7.9	12.7	14.3	3.6	23.0		
in	3/8	9/16	1/2	25/64	13/16	042419	N/A
mm	9.5	14.3	12.7	9.9	20.6		

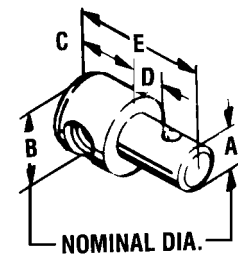

Teleflex Marine Connection Kits

DESCRIPTION OF KIT

MORSE

TELEFLEX

Other Universal Cable Connection Kits, continued:

3300/33C Series:

Eye Terminal (Metal) - 3300 (10-32, 5/16" pin) (1)	031980	N/A
Eye Terminal (Red Nylon) - 3300 (10-32, 5/16" pin) (1)	300646	N/A

4300/43 Series:

Eye Terminal - 4300/43 (1/4-28, 5/16" pin) (1)	041134	N/A
--	--------	-----

6400/64 Series:

Eye Terminal - 6400/64 (5/16-24, 5/16" pin) (1)	045428	N/A
---	--------	-----

Pin for Eye Terminal (1.5", 5/16" dia.) (pin only)	300965	N/A
Pin for Eye Terminal (1.687", 5/16" dia.) (pin only)	047383	N/A
Terminal Pin Kit (300965, ring, nut, washer)	301456	N/A
Spring Link Terminal - 3300/33C Cables	031545	N/A

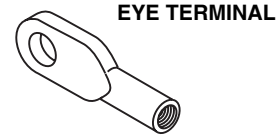

EYE TERMINAL

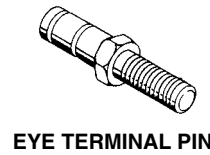

EYE TERMINAL PIN

SPRING LINK TERMINAL

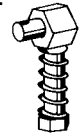

Univ. 3300/33C Clamp & Shim Kit (1)	N/A	CA28020P
Univ. 3300/33C Clamp (1)	032010	N/A
3300/33C Clamp (for bare conduit) (1)	037664	N/A
3300/33C Clamp (for bare cond. or ftg.) (1)	031509	N/A
3300/33C Clamp Shim for 032010 (1)	035777	N/A



CLAMP

Univ. 4300/43 Clamp & Shim Kit (1)	N/A	CA28018P
Univ. 4300/43 Clamp - 2 Holes (1)	031532	N/A
Heavy Duty 4300/43 Clamp - 4 Holes (1)	021227	N/A
4300/43 Clamp Shim for 031532 & 021227 (1)	031538	N/A
<i>(NOTE: 2 shims required for each 021227 clamp.)</i>		

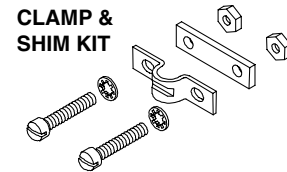

CLAMP & SHIM KIT

Univ. 6400/64 Clamp & Shim Kit (1)	N/A	CA28019P
Heavy Duty 6400/64 Clamp - 4 Holes (1)	036733	N/A
6400/64 Clamp Shim (1)	031538	N/A

Univ. 3300/33C Inboard Connection Kit (2)	N/A	CA27024P
<i>(Above contains: (2) CA37701P Ball Joints & (2) CA35074P Brackets.)</i>		

Univ. 3300/33C Inboard Connection Bracket	N/A	CA35074P
Univ. 3300/33C Inboard Connection Bracket (1)	036174	N/A

(Old Morse description: "Cable Hook Clip - Single")

Univ. 3300/33C Inboard Connection Bracket (1)	031419	N/A
---	--------	-----

(Old Morse description: "Cable Clip - 30 Series Only")

Univ. 3300/33C Parallel Connection Kit (2)	N/A	CA27328P
Univ. 3300/33C Parallel Connection Kit (2)	035531	N/A

(Old Morse description: "Cable Hook Clip - Dual")

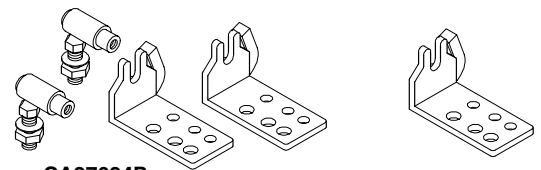

CA27024P

CA35074P
036174
031419

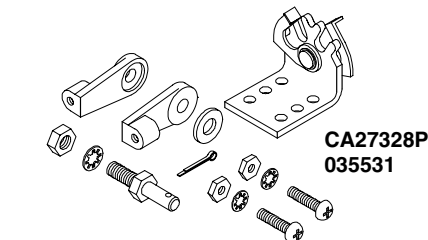

CA27328P
035531

Other Cable Kits/Accessories:

Anti-Vibration Cable Mount - 3300/33C	294200	N/A
Anti-Vibration Cable Mount - 4300/43	294201	N/A
Stop Collar - 3300/33C	037693	N/A
Cable Brake - 3300/33C, 4300/43 & 6400/64 Cables	044386	N/A

ANTI-VIBRATION
CABLE MOUNT

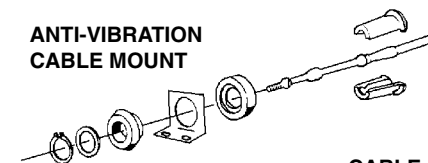

STOP COLLAR

CABLE
BRAKE



control cable connection & accessory hardware

For two cables, except where otherwise noted.
(1) = for use with one cable.

DESCRIPTION OF KIT	MORSE	TELEFLEX
--------------------	-------	----------

Conduit Fitting [Hub] Adapter Kits for Panel/Utility Cables:

Bulkhead Adapter Kit - Panel Cables	300673	N/A
Clamp Adapter Kit - Panel Cables	302485	N/A



All-Purpose Clutch & Throttle Kits - BY PART NUMBER:

Connection Kit - 3300/33C Cable	036680	N/A
Connection Kit - 4300/43 Cable	040773	N/A
Connection Kit - Dual Station 3300/33C (TwinDisc)	042577	N/A
Clutch Kit - Twin Disc (right)	063696	N/A
Throttle Kit - 3300/33C Cable (Cummins)	300580	N/A
Adapter Kit - 4300/43 Cable (Cummins, GM, Borg-Warner, Twin Disc)	300580	N/A

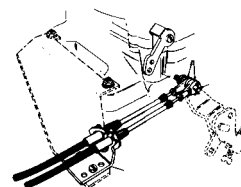

036680

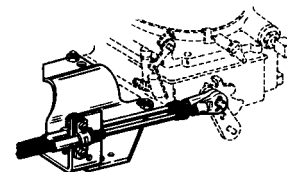

040773

Pre-Engineered Clutch & Throttle Kits - BY ENGINE APPLICATION:

For Single Station 3300/33C Cables:

Caterpillar 334, 3304 & 3306	036680	N/A
Caterpillar 343, 3406 & 3408	036680	N/A
Cummins (all with MVSGOV)	036680	N/A
Cummins (V, VT, KT, KTA 1975-up)	300580	N/A
GM (6, 8 & 12 V-71, 6 & 8 V-92 w/v.s.g.)	N/A	N/A
GM (2, 3 & 4-53 w/left & right hand gov.)	036680	N/A
GM (GV-53 rear & front entry)	036680	N/A
GM (6 & 8V-71 front entry shutdown kit)	036680	N/A
Universal (Atomic 4)	036680	N/A
Universal (Atomic 1&2 63C clutch & 33C throttle)	036680	N/A

For Dual Station 4300/43C Cables:

Caterpillar 334, 3304 & 3306	036680	N/A
Caterpillar 343, 3406 & 3408	036680	N/A
Cummins (all with MVSGOV)	036680	N/A
Cummins (V, VT, KT, KTA 1975-up)	300580	N/A
GM (6, 8 & 12 V-71, 6 & 8 V-92 w/v.s.g.)	N/A	N/A
GM (2, 3 & 4-53 w/left & right hand gov.)	036680	N/A
GM (GV-53 rear & front entry)	036680	N/A
GM (6 & 8V-71 front entry shutdown kit)	036680	N/A
Universal (Atomic 4)	036680	N/A
Universal (Atomic 1&2 63C clutch & 33C throttle)	036680	N/A

To convert from 3300/33C Dual Station to 4300/43C Dual Station, add:

Caterpillar 334, 3304 & 3306	040773	N/A
Caterpillar 343, 3406 & 3408	040773	N/A
Cummins (all with MVSGOV)	040773	N/A

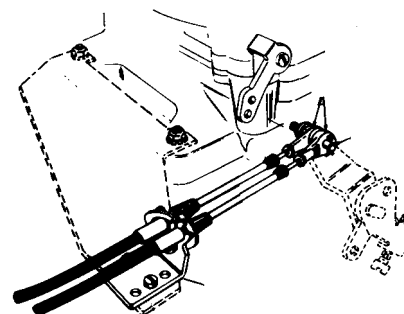

036680
300580

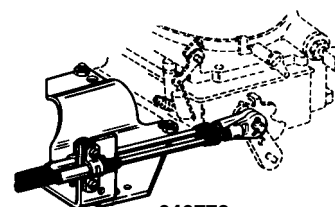

040773
300665

(listing continued on next page)

CONTROL CABLES connection kits

Teleflex Marine Connection Kits

For two cables, except where otherwise noted.
(1) = for use with one cable.

DESCRIPTION OF KIT	MORSE	TELEFLEX
--------------------	-------	----------

To convert from 3300/33C Dual Station to 4300/43C Dual Station, add:

Cummins (V, VT, KT, KTA 1975-up)	300665	N/A
GM (3,4 & 6-71 w/var. spd. Gov.)	300665	N/A
GM (6, 8 & 12 V-71, 6 & 8 V-92 w/v.s.g.)	300665	N/A
GM (2, 3 & 4-53 w/left & right hand gov.)	040773	N/A
GM (GV-53 rear & front entry)	040773	N/A
GM (6 & 8V-71 front entry shutdown kit)	040773	N/A
Universal (Atomic 4)	040773	N/A
Universal (Atomic 1&2 63C clutch & 33C throttle)	040773	N/A

Pre-Engineered Clutch & Throttle Kits - BY TRANSMISSION:

For Dual Station 3300/33C Cables:

Borg-Warner (70, 71 & 72 inline-red gear)	301474	N/A
Borg-Warner (71C & 72C drop center)	N/A	N/A
Capital (12400, 2, 3 & 4 HD & HE)	036680	N/A
Paragon (HF-7)	036680	N/A
Twin Disc (MG, 508, 509, 510, 510A, 512)	042577	N/A
Twin Disc (514C, 514CHP, 518, 521, 527)	042577	N/A
Twin Disc (530 & 540)	042577	N/A
Twin Disc (MG502, 506 & 507)	063696 (right)	N/A

For Dual Station 4300/43C Cables:

Borg-Warner (70, 71 & 72 inline-red gear)	301474	N/A
Borg-Warner (71C & 72C drop center)	N/A	N/A
Capital (12400, 2, 3 & 4 HD & HE)	036680	N/A
Paragon (HF-7)	036680	N/A
Twin Disc (MG, 508, 509, 510, 510A, 512)	N/A	N/A
Twin Disc (514C, 514CHP, 518, 521, 527)	N/A	N/A
Twin Disc (530 & 540)	N/A	N/A
Twin Disc (MG502, 506 & 507)	N/A	N/A

To convert from 3300/33C Dual Station to 4300/43C Dual Station, add:

Borg-Warner (70, 71 & 72 inline-red gear)	300665	N/A
Borg-Warner (71C & 72C drop center)	300665	N/A
Capital (12400, 2, 3 & 4 HD & HE)	040773	N/A
Paragon (HF-7)	040773	N/A
Twin Disc (MG, 508, 509, 510, 510A, 512)	300665	N/A
Twin Disc (514C, 514CHP, 518, 521, 527)	300665	N/A
Twin Disc (530 & 540)	300665	N/A
Twin Disc (MG502, 506 & 507)	300665	N/A

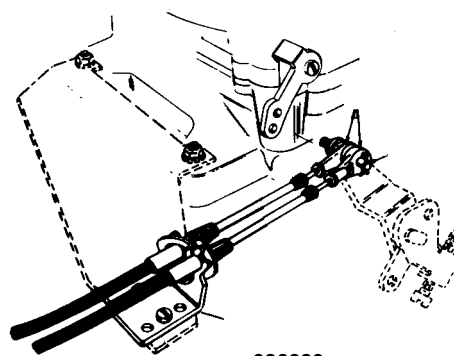

036680
301474
042577

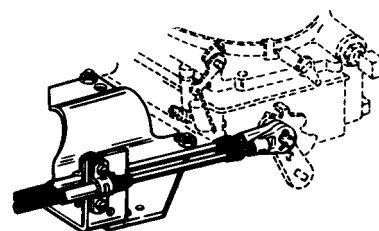

040773
300665

For more information about Teleflex Marine connection kits, please contact Teleflex Marine at 610-495-7011 or visit us on-line at www.teleflexmarine.com