

Low Profile Hatch

The sleekly designed Low Profile Hatch is ideal for use on a powerboat. Smaller ventilation hatches are a better fit for sailboats, while the larger sizes can be used as foredeck hatches on smaller to mid size yachts.



CE Approved Complies with the relevant parts of International Standards ISO/DIS 12216.2(E). This standard covers the applicable essential safety requirements of the Recreational Craft Directive 94/25/EC.

Size	Area 2a
All Sizes	✓

Note: Area 2a = Deck, Coachroof, Cockpit & Transom

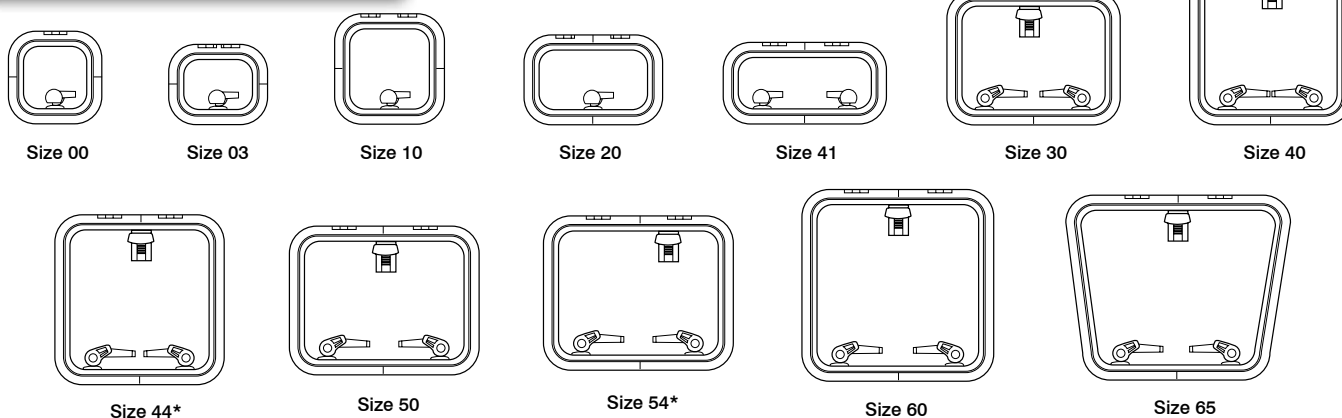

* Minimum size for ISO 9094 escape hatches

Low Profile Hatch Dimensions

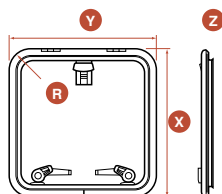

Low Profile Hatch Cut-Outs

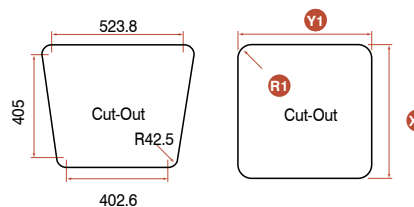

Low Profile Hatch Specifications

Part Number Self Supporting Lid	Part Number Hatch With Supporting Telescopic Stay	Size	Lower Frame Flange		Overall Size								Cut-Out Size Dimensions change if Trimkits are used			Hatch Weight		Acrylic Window Thickness				
			mm	in	X Length mm in	Y Width mm in	Z Height mm in	R Radii mm in	X1 Length mm in	Y1 Width mm in	R1 Radii mm in	kg	lb	mm	in							
39900030		00	15	9/16	281	11 1/16	281	11 1/16	25	1	72.5	2 7/8	211	8 5/16	211	8 5/16	42.5	1 11/16	1.6	3.5	8	5/16
39903030		03	15	9/16	246	9 11/16	301	11 7/8	25	1	72.5	2 7/8	176	6 15/16	231	9 1/8	42.5	1 11/16	1.6	3.5	8	5/16
39910030	399100303	10	15	9/16	330	13	330	13	25	1	72.5	2 7/8	260	10 1/4	260	10 1/4	42.5	1 11/16	2.2	4.9	8	5/16
39920030		20	15	9/16	272	10 11/16	417	16 7/16	25	1	72.5	2 7/8	202	7 15/16	347	13 11/16	42.5	1 11/16	2.3	5.1	8	5/16
39930030	399300303	30	15	9/16	397	15 5/8	527	20 3/4	25	1	72.5	2 7/8	327	12 7/8	457	18	42.5	1 11/16	4.2	9.3	8	5/16
39940030	399400303	40	15	9/16	491	19 5/16	491	19 5/16	25	1	72.5	2 7/8	421	16 9/16	421	16 9/16	42.5	1 11/16	4.6	10.1	8	5/16
39941030		41	15	9/16	246	9 11/16	491	19 5/16	25	1	72.5	2 7/8	176	6 15/16	421	16 9/16	42.5	1 11/16	2.5	5.5	8	5/16
39944030	399440303	44	15	9/16	512	20 3/16	512	20 3/16	25	1	72.5	2 7/8	442	17 3/8	442	17 3/8	42.5	1 11/16	4.8	10.6	8	5/16
39950030	399500303	50	15	9/16	447	17 5/8	577	22 11/16	25	1	72.5	2 7/8	377	14 13/16	507	19 15/16	42.5	1 11/16	4.8	10.6	8	5/16
39954030	399540303	54	15	9/16	462	18 3/16	577	22 11/16	25	1	72.5	2 7/8	392	15 7/16	507	19 15/16	42.5	1 11/16	4.9	10.8	8	5/16
39960030	399600303	60	15	9/16	577	22 11/16	577	22 11/16	25	1	72.5	2 7/8	507	19 15/16	507	19 15/16	42.5	1 11/16	6.4	14.1	10	3/8
39965030		65	15	9/16	560	22 11/16	560 min 675 max	22 11/16 min 26 9/16 max	25	1	72.5	2 7/8	See drawing			42.5	1 11/16	6.5	14.3	10	3/8	

- Hatches should be fitted to a flat surface with a maximum tolerance of ± 1 mm
- Fastening size for lower frame section use 5mm CSK screws No. 10 UNC 2BA

- Fastening size at the hinge section use M6 (1/4")
- Cut-out dimensions change if a Trimkit is used